

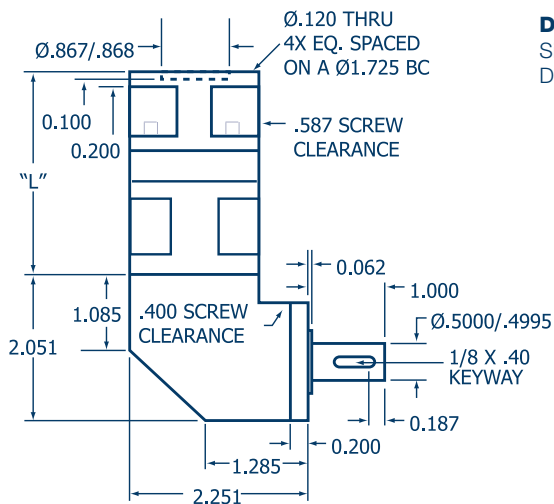

SIZE 17 RIGHT ANGLE PRECISION PLANETARY



DIMENSION "L"

Single Stage (3:1 to 10:1) = 2.869 ± .015
 Double Stage (16:1 to 100:1) = 3.738 ± .015

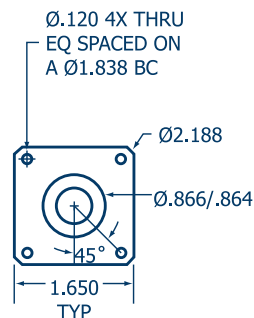

Part #	Ratio	Continuous output torque at 1500 rpm input (in-lbs)	Continuous output torque at 3500 rpm input (in-lbs)	Continuous output torque at 5000 rpm input (in-lbs)	Gearhead inertia at input (lb-in-sec ²)	
SINGLE STAGE	17RP003	3:1	80	80	80	4.96 x 10 ⁻⁵
	17RP004	4:1	80	80	80	2.56 x 10 ⁻⁵
	17RP005	5.5:1	80	80	80	1.61 x 10 ⁻⁵
	17RP007	7:1	80	80	80	1.27 x 10 ⁻⁵
	17RP010	10:1	80	80	80	9.90 x 10 ⁻⁶
DOUBLE STAGE	17RP016	16:1	100	100	100	1.65 x 10 ⁻⁵
	17RP022	22:1	100	100	100	1.13 x 10 ⁻⁵
	17RP028	28:1	100	100	100	9.74 x 10 ⁻⁶
	17RP040	40:1	100	100	100	8.45 x 10 ⁻⁶
	17RP049	49:1	100	100	100	9.50 x 10 ⁻⁶
	17RP055	55:1	100	100	100	8.36 x 10 ⁻⁶
	17RP070	70:1	100	100	100	8.33 x 10 ⁻⁶
	17RP100	100:1	100	100	100	8.31 x 10 ⁻⁶

GENERAL SPECIFICATIONS

Construction Type	Ratio	Backlash: Standard (arc-minutes)	Backlash: Low Backlash (arc-minutes)	Efficiency	Weight (lbs)	Maximum Tested Input rpm
Single Stage	3:1 to 10:1	10	7	90%	1.82	5000
Double Stage	16:1 to 100:1	14	11	85%	2.42	5000

PEAK TORQUE: 15% above continuous rating. **NOTE:** Repeated peak torque loading may cause failure.